

# SESG – USN 24 NOV

V-model - Interface between customer and supplier.

Simon Løkja Følling



# SUBSEA PRODUCTION SYSTEM (SPS)

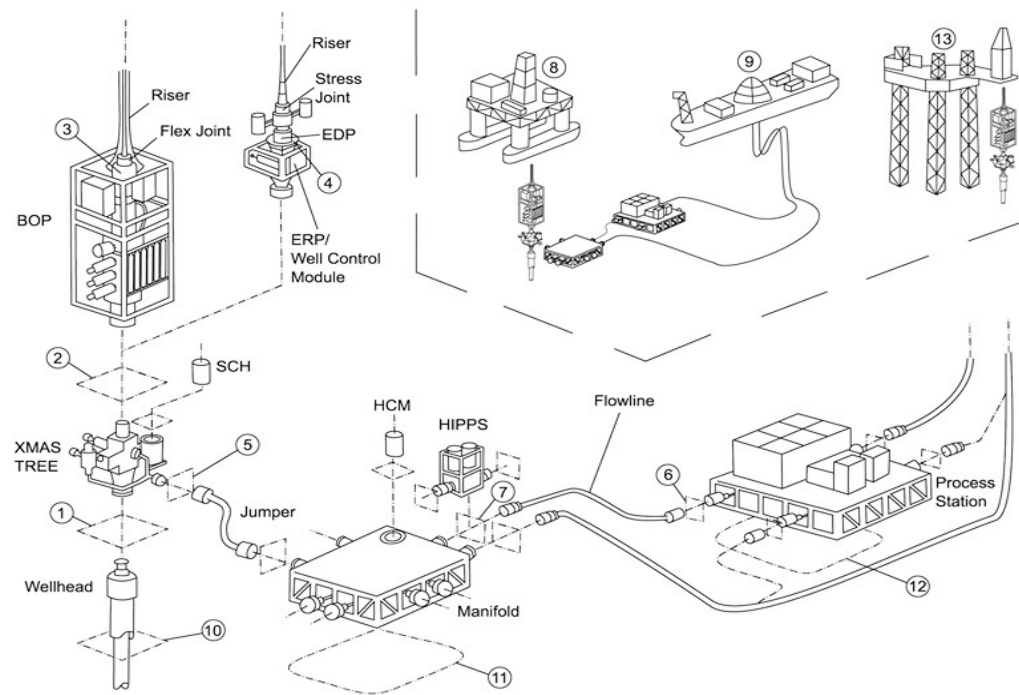

Example of subsea production system architecture with interfaces

# THE V-MODEL FOR SUBSEA PROJECTS

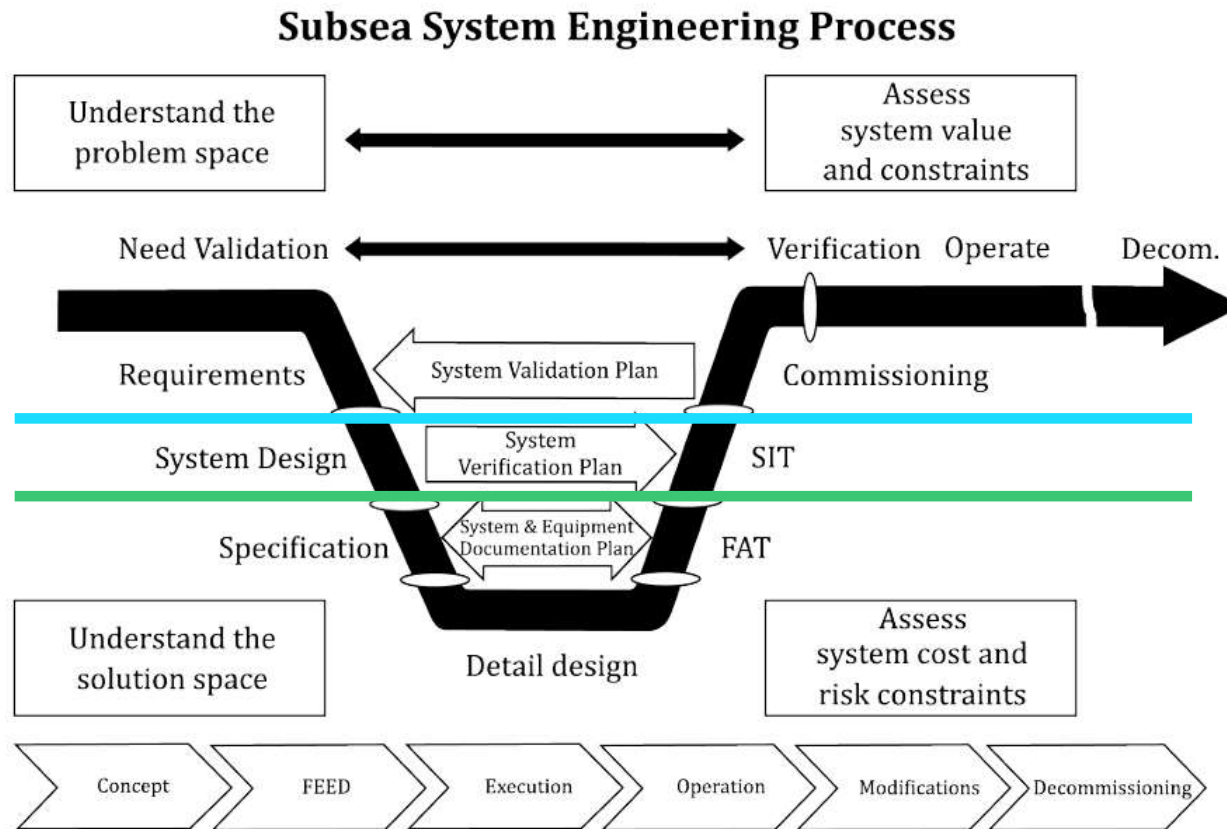



# CUSTOMER INVOLVEMENT – SPS PROJECT

- Project management
- QHSE – Quality Health Safety Environment
- Engineering management
- Interface management
- Design reviews (System, sub system, modules)
- Technical safety reviews
- Documentation review
- Pre-production meetings
- Test/Verification (witnessing/hold) (SIT/SUT, FAT, EFAT)
- MC – Mechanical Completion

# SPS PROJECT PHASES

## Traditional schedule

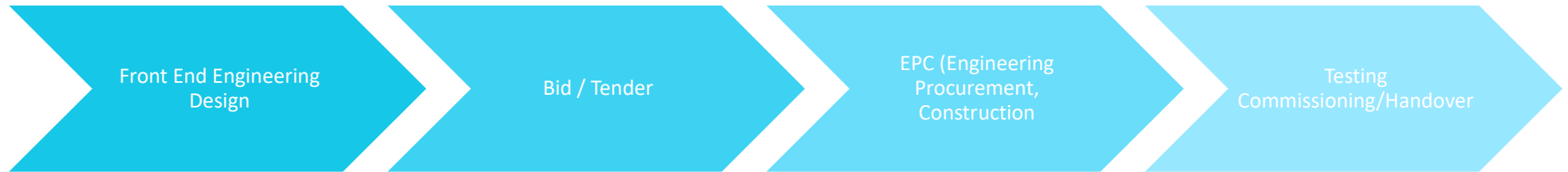

## Accelerated schedules

Combine study, Tender, project start up (long lead items)

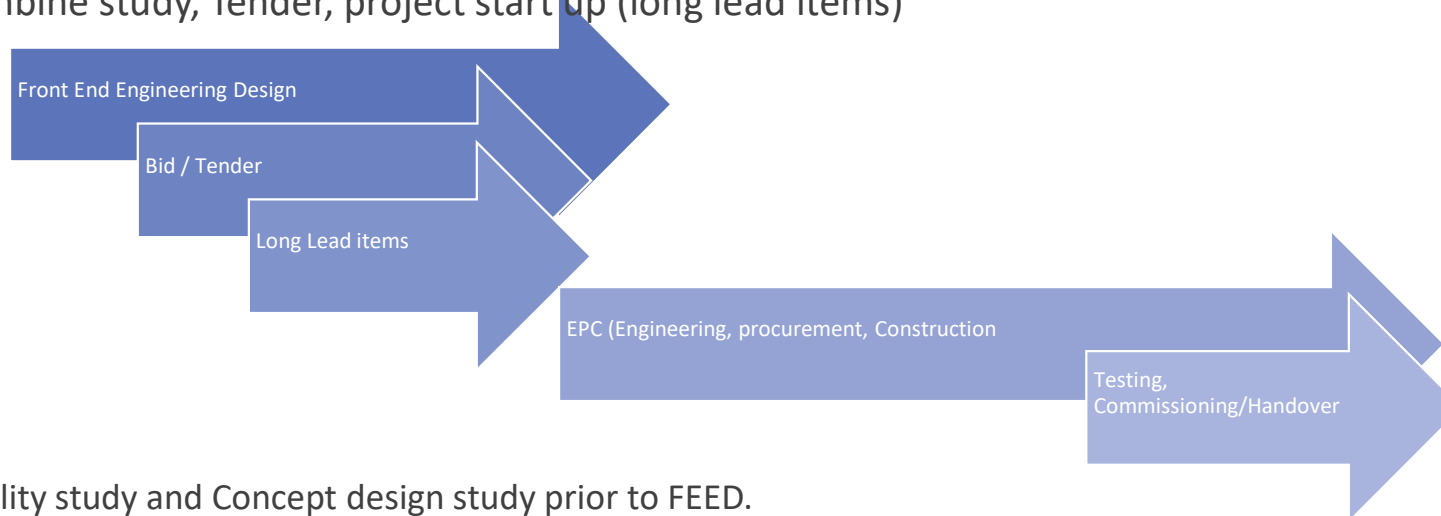

Note! Feasibility study and Concept design study prior to FEED.



## HOW CAN THIS BE SOLVED?

- Agreement from Feed and tender prior to starting project execution
- Agree requirements
- Agree interfaces
- Agree phase in the V-model for customer involvement
- Define responsibilities for customer – supplier and suppliers vendors

S E R V I C E  
Q U A L I T Y  
S A T I S F A C T I O N  
L O Y A L T Y  
S U P P O R T  
C O M M U N I C A T I O N  
F E E D B A C K  
T R U S T



THANK YOU

